



## Corrosion coupon insertion without source depressurization!

The Direct Drive™ Model 751 coupon holder probe allows a corrosion coupon to be inserted and retracted from a pressurized source through a full port valve without the use of a special insertion device or the force and bulky equipment associated with pneumatic or hydraulic methods. Its adjustable probe depth up to the maximum specified probe length allows precise positioning of the coupon within the pipeline or process.



### Technical Specifications

<b>Maximum Pressure Rating</b>	NPT: 3,750 psig (258.6 barg) Unibody flanged: ANSI classification specific
<b>Temperature Range</b>	-40°F (-40°C) to 300°F (149°C) * Actual limit depends on sealing material chosen. Refer to Temperature Range Comparison Chart.
<b>Port Size</b>	Auxiliary: 1/8" female NPT with vent valve installed from the factory
<b>Probe Lengths</b> for other lengths contact the factory	L: 8", 12", 18", 24", 36", 48" A: ~ 16", 20", 26", 32", 44", 56" refer to L & A dimensions on back
<b>Process Connection Requirement</b>	3/4", 1" or 1.5" NPT full opening threaded or flanged valve Ball, gate and double block and bleed valves are all suitable for use as long as their inner diameter is not less than 3/4". 1" NPT or larger process connection required for seal welding.
<b>Valve Requirement</b> customer provided	Straight-through path with minimum bore of 0.75" (1.91 cm)
<b>Wetted Materials</b>	Machined parts: 316/316L stainless steel / NACE compliant and Kevlar® threaded bushing All other metal parts: stainless steel / NACE compliant Sealing material: User Defined
<b>Coupon Attachment Tip</b> refer to dimensions on back	Tip accepts 1/16" thick flat coupon Customer supplied coupon-not included

### Product Brief

#### Applications

- Corrosion coupon insertion and extraction from a pressurized system
- Gas sampling of mixtures containing less than 30% hydrogen

#### Benefits

- Easy, quick, safe insertion and extraction from a pressurized source without a special insertion device
- Field serviceable packing gland
- Standard coupon attachment tip can be modified to fit other coupon types
- Velocity tested at CEESI flow lab up to 200 ft/sec

#### Features

- Patented insertion method
- Patented harmonic resonance dampening design
- Adjustable length with threaded or flanged process connection
- Proprietary antifriction coating with internal thread die
- Optional speed wrench for faster installation



## Model Numbering & Additional Part Numbers

Your model number is determined by your specific needs. Choose options below.

<b>Sealing material</b>	0 = PTFE/Neoprene rubber	J = RGD resistant HNBR	(other materials available upon request)
<b>Coupon attachment</b>	1 = 1/16" flat coupon	(other coupon connections available upon request)	
<b>Process connection</b>	3 = 3/4" NPT	4 = 1" NPT	6 = 1.5" NPT
<b>Probe insertion length</b>	8, 12, 18, 24, 36, 48 inches		
<b>Sealing material replacement</b>	Part # 75X-5_0	(sold separately - contains PTFE/Neoprene seals)	
<b>Coupon mounting replacement</b>	Part # 751-TI-1	(sold separately - contains 10/32 mounting screws & PTFE inserts)	
<b>Speed wrench</b>	Part # ACC-SW	(sold separately)	

How to build the model number:

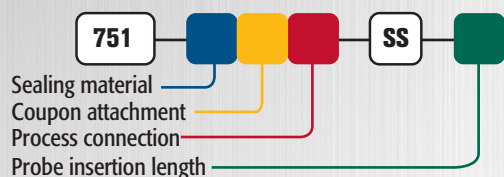

## Dimensions

Uninstalled

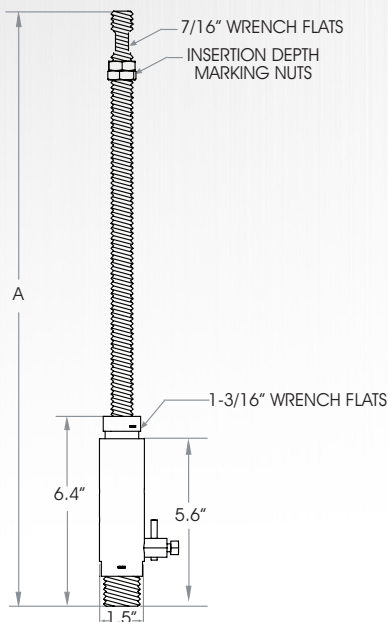

Installed

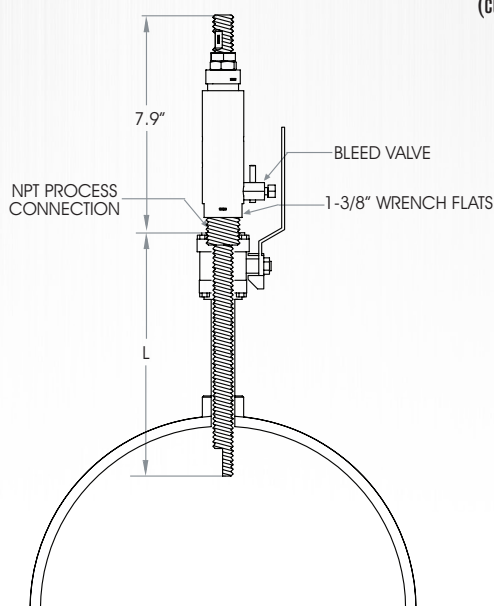

Standard Coupon Size

(customer supplied coupon-not included)

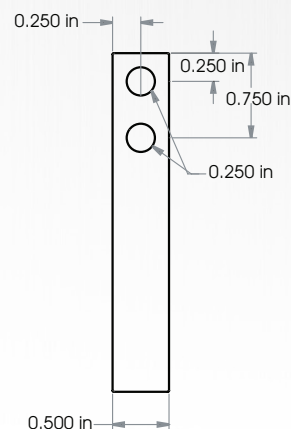

Analytically Correct™ sample systems, sample conditioning components, and revolutionary gas and liquid sampling technology.

Contact us for expert product application assistance.

1.225.644.5255

sales@geniefilters.com

geniefilters.com

41041 Black Bayou Road, Gonzales, Louisiana 70737

